

N:\Active\2008\1122 - Environmental\08-1122-0359 Findlay Creek Stage 2 Sanitary Outfall\GIS\mxd\08-1122-0359\_04.mxd

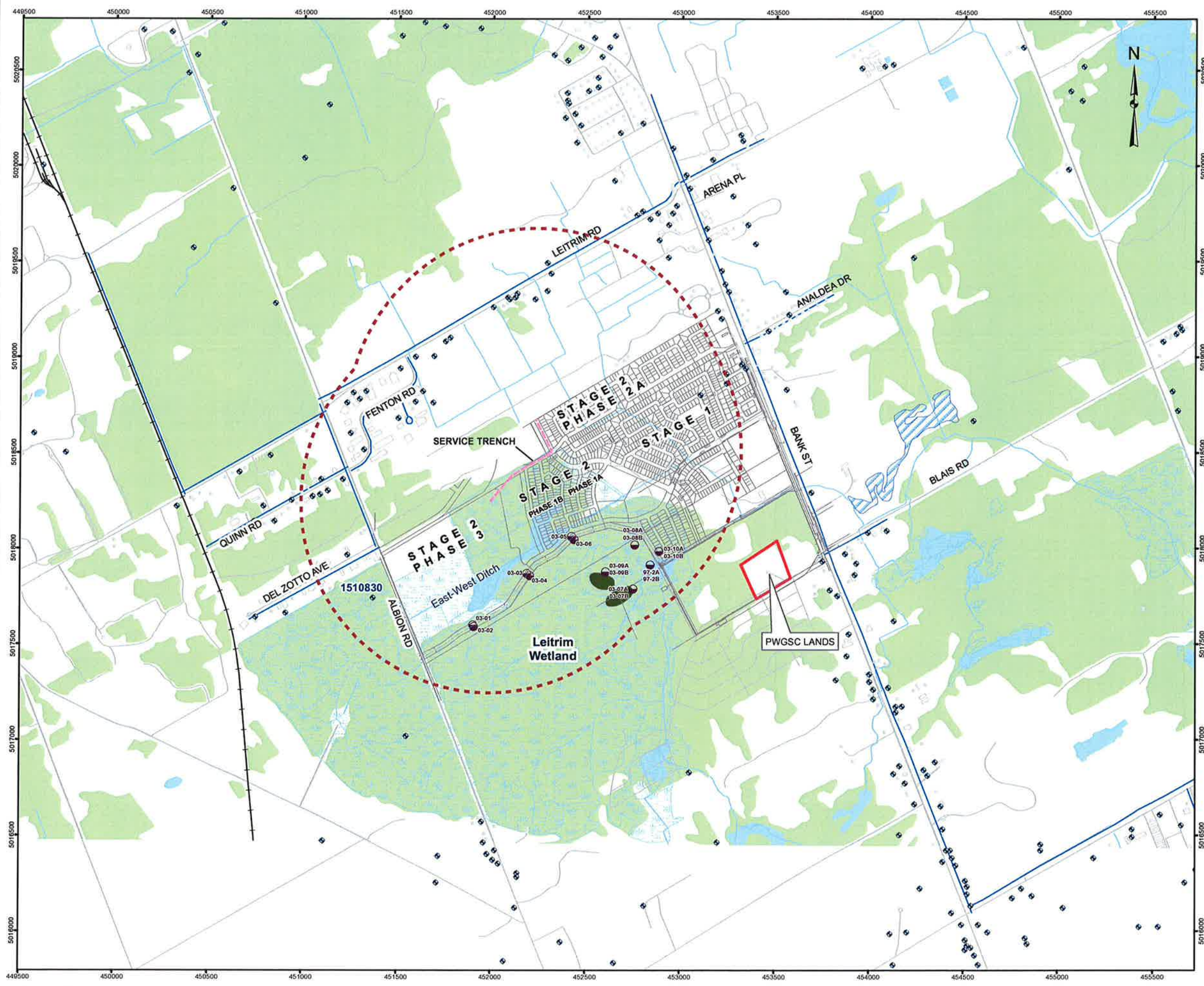

**LEGEND**

- Monitoring Well
- MOE-Listed Water Well
- Building
- Building Outline
- Service Trench
- 1000 m Radius of Influence Around Service Trench
- Roadway
- Proposed Lot Layout
- City of Ottawa Watermain Service
- Watercourse
- Wetland
- Waterbody
- Wooded Area
- Stormwater Management Pond
- Fen

**NOTE:**  
 This figure is to be read in conjunction with the accompanying Golder Associates Ltd. report No. 08-1122-0359

**REFERENCE:**  
 Digital OBM NRVIS data provided by Ontario Ministry of Natural Resources Queen's Printer, used under licence, 2006  
 Base plan provided by Stantec Geomatics Ltd.  
 Projection: Transverse Mercator Datum: NAD 83 Coordinate System: UTM Zone 18



<b>PROJECT</b>			
FINDLAY CREEK VILLAGE - STAGE 2 PHASE 3 SEWER OUTLET PTTW APPLICATION			
<b>TITLE</b>			
AREA OF INFLUENCE AND MOE-LISTED WATER WELLS			
	PROJECT No.08-1122-0359	SCALE AS SHOWN	REV. 1
	DESIGN JPAO 04 DEC. 2008		
	CHECK BT 04 DEC. 2008		
	REVIEW PAS 10 DEC. 2008		
			FIGURE: 4