

N:\Active\2007\1122 - Environmental\07-1122-0277 Findlay Creek PTTW\GIS\mxd\Phase2000\07-1122-0277--2000-02-REV1.mxd

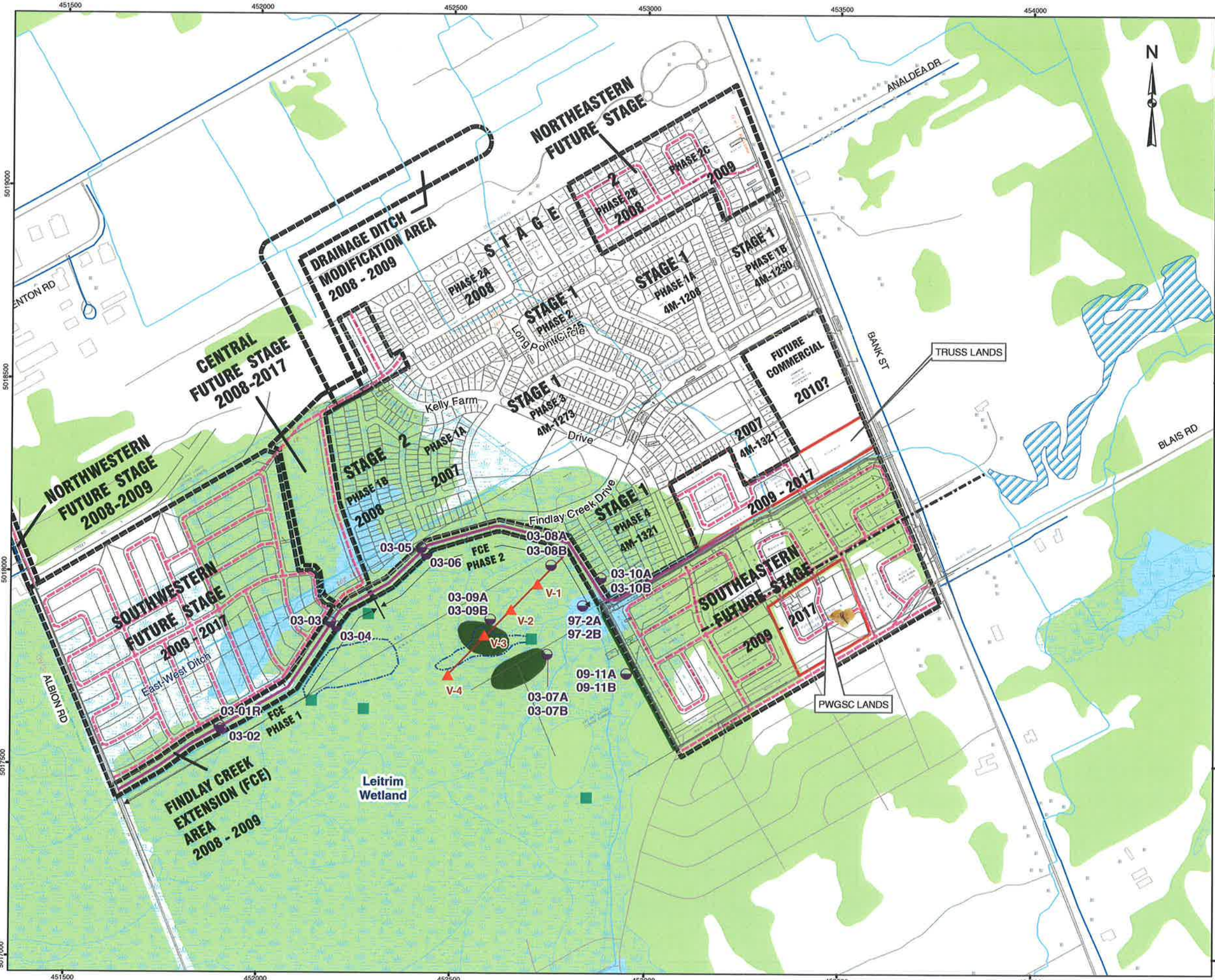

LEGEND

- V-1 Vegetation Monitoring and Photomonitoring Plot Location
- Vegetation Monitoring Transect
- 03-06 Monitoring Well
- Regionally Significant and Uncommon Vegetation Monitoring Plot
- Peat Surface Level Monitoring Post Location
- Building
- Building Outline
- Railroad
- Roadway
- Proposed Lot Layout
- City of Ottawa Watermain Service
- Watercourse
- Wetland
- Waterbody
- Wooded Area
- Future Stage / Area
- Findlay Creek Extension
- Wetland Berm
- Stormwater Management Pond
- Fen
- Trunk Storm Sewer
- Service Trench

REFERENCE

Digital OBM NRVIS data provided by Ontario Ministry of Natural Resources Queen's Printer, used under licence, 2006
 Base plan provided by Stantec Geomatics Ltd.
 Projection: Transverse Mercator Datum: NAD 83 Coordinate System: UTM Zone 18



REV.	DESCRIPTION	DATE
1	Additional Monitoring Components	19 Nov. 2009

PROJECT: FINDLAY CREEK VILLAGE - FUTURE STAGES PTTW APPLICATION

TITLE: PSW VEGETATION MONITORING COMPONENT

	PROJECT No. 07-1122-0277-2009	SCALE AS SHOWN	REV. 1
	DESIGN PAS 19 Oct. 2009		
	GIS BT 19 Nov. 2009		
	CHECK		
	REVIEW		

FIGURE: MP-2