

DECISION

With respect to Amendment No. 180 to the City of Ottawa's Official Plan Subsection 17(34) of the *Planning Act*

I hereby approve all of Official Plan Amendment No. 180 to the City of Ottawa's Official Plan, adopted by By-law 2017-19, subject to the following modifications:

1. **Item 12 - Section 3.6.5 - Employment Area and Enterprise Area** is hereby modified by inserting the following text after the second sentence of the third paragraph of the new policy "3.6.5 – Urban Employment Area" of bullet point c):

"Urban Employment Areas should be developed so that the main gateway connecting to a nearby highway interchange is unencumbered by driveways or multiple interconnected roadways to reduce conflicts between transit, cycling, walking facilities and to maximize goods movement efficiency. Driveway entrances to large traffic generators within nodes should be from roads that are not directly connected to interchanges, leaving the main development frontages directly connected to transit, walking and cycling facilities."

2. **Item 17 - Section 3.7.3 - Agricultural Resources** is hereby modified by inserting a bullet point "a)" prior to the word "Amend", and by inserting a new bullet point "b)" after the words "The purpose of this designation is to:" which shall read as follows:

"b) Add immediately following the modified policy 1, a new policy 2 to read as follows, and re-numbering the subsequent policies accordingly:

2. The City will only consider the removal of land from an Agricultural Resource Area designation if it is demonstrated, through a comprehensive review undertaken by the city and addressing the matters required by the Provincial Policy Statement, that the land is required for the expansion of a settlement area."

3. **Item 18 - Section 3.7.3 - Agricultural Resources** is hereby modified by:

a) Deleting the second sentence in new policy 2 and replacing it with the following:

"This includes best management practices and activities related to the conservation or management of the natural environment. Agricultural uses should also respect the provincial Guidelines on Permitted Uses in Ontario's Prime Agricultural Areas."

b) Deleting the first sentence of new policy 3 and replacing it with the following:

"On-farm diversified uses and agriculture-related uses that are compatible with, and do not hinder surrounding agricultural operations may be permitted subject to the criteria below and the Provincial Guidelines."

c) Deleting new policy 4 which reads "Uses such as forestry and those related to the conservation or management of the natural environment are also permitted" in its entirety.

4. **Item 19 - Section 3.7.3 - Agricultural Resources** is hereby modified by deleting the section in its entirety and replacing it with the following:

“Amend policy 3, by deleting the second and third sentences and replacing them with the following:

Accommodation for full-time farm labour is permitted when the size and nature of the operation requires additional employment. It may be located on the same lot as the farmhouse and should preferably take the form of a mobile home, as defined in the zoning by-law, so that it can be removed once the farm help is no longer required.”

5. **Item 20 - Section 3.7.3 - Agricultural Resources** is hereby modified by adding a new sub-section as follows:

“c) Delete the word “Wayside” from the sub-heading “Wayside Pits and Quarries” after policy 5 and replace policy 6 entirely with the following new policy:

“6. New mineral aggregate extraction operations may be permitted as an interim use in the Agricultural Resource Area designation subject to a site specific exemption in this plan and only where the provisions of Section 2.5.4.1 of the Provincial Policy Statement and Section 3.7.4 of this Plan have been addressed. Wayside pits and quarries, portable asphalt plants and portable concrete plants are permitted subject to Section 3.1 of this plan.”

6. **Item 22 - Section 3.7.5 - Carp Road Corridor Rural Employment Area** is hereby modified by:

a) inserting the following new paragraph at the end of the third paragraph of the preamble in section b): ***“Rural Employment Areas reflect long established rural industrial clusters and apply predominantly in existing strategic locations in rural areas of the City.”*** and

b) inserting a new policy 4 in subsection b) to read as follows:

“4. All new development proposed within the Ministry of Transportation’s permit control area must address driveway access proximity to the interchange that is in keeping with the Ministry’s Access Management Guideline.”

7. **Item 31 – Schedule A- Rural Policy Plan** is hereby modified by inserting the words ***“and east”*** after the word ***“South”*** in the first bullet point.

8. **Item 34 – Schedule A- Rural Policy Plan** is hereby modified by deleting the word ***“three”*** and replacing it with the word ***“two”***.

9. Schedule R6, dated January 25, 2017 is hereby deleted and replaced with a new Schedule R6, dated June 2017. The new Schedule R6 is attached hereto, and forms part of the Decision.

10. Schedule R12, dated January 25, 2017 is hereby deleted and replaced with a new Schedule R12, dated June 2017. The new Schedule R12 is attached hereto and forms part of the Decision.

11. Schedule R21, dated January 25, 2017 is hereby deleted and replaced with a new Schedule R21, dated June 2017. The new Schedule R21 is attached hereto and forms part of the Decision.

Dated at Kingston this 8th day of August, 2017



Allan Scott, Regional Director
Municipal Services Office- Eastern
Ministry of Municipal Affairs/Ministry of Housing

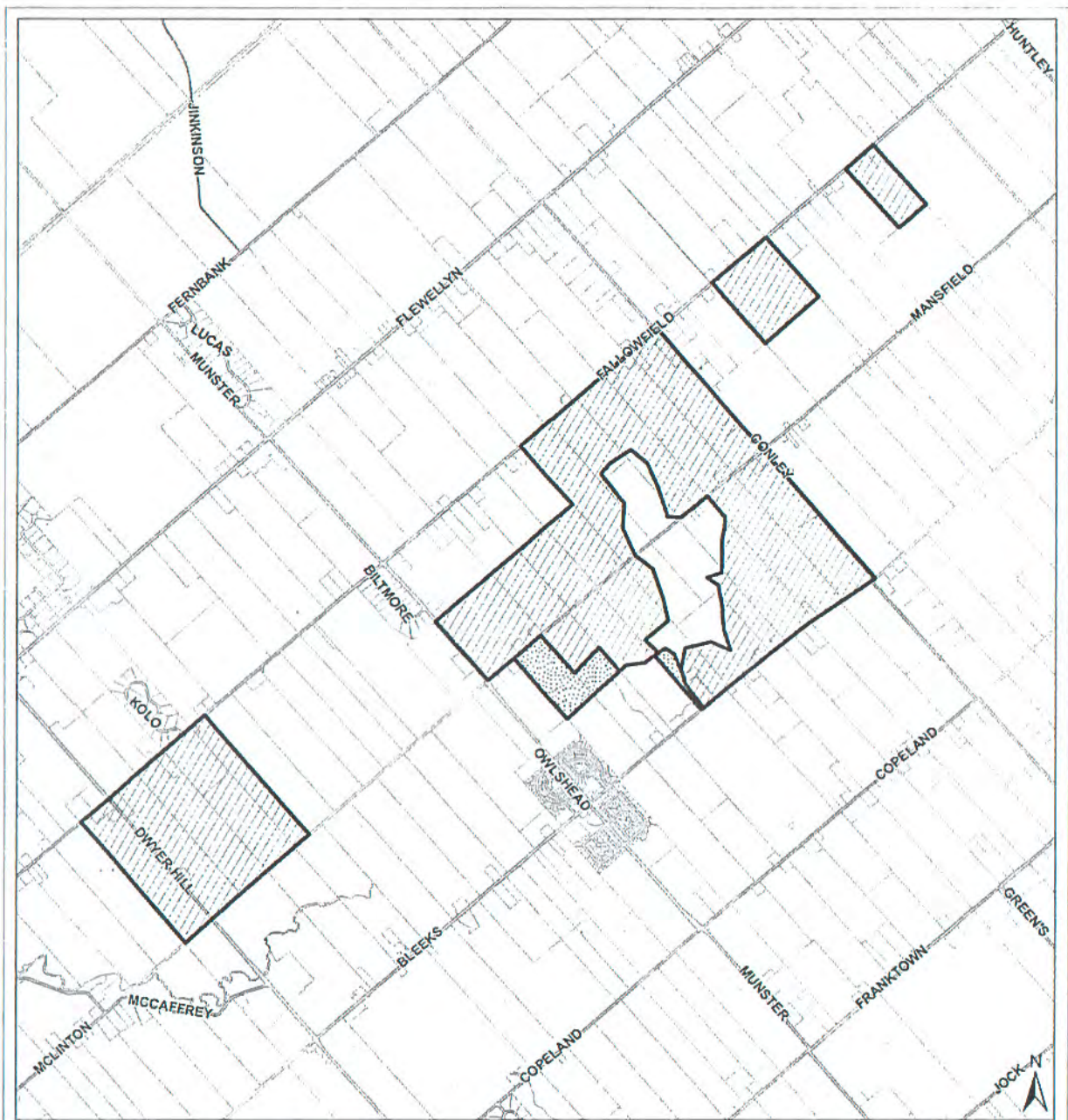

Prepared by:
Planning, Infrastructure and Economic Development Department,
Geomatics, Mapping and Graphics Unit



Préparé par: Services de la planification
de l'infrastructure et du développement économique,
Unité des Géomatiques, cartographie et graphiques

D01-01-16-0014 16-1261-A

ES:\ASStaff\Shelly\CPN\2016\CPA 1610 Map R6.mxd

Revision: 06/2017 Rev #: 1

© 2017. All rights reserved. All other trademarks are the property of their respective owners.
Tous droits réservés. Tous autres marques sont la propriété de leurs respectifs propriétaires.



Scale - N.T.S. / Echelle N.A.L.

**SCHEDULE R6 to
AMENDMENT NO.180**

to the OFFICIAL PLAN
for the CITY OF OTTAWA
Amending Schedule A
Rural Policy Plan

**ANNEXE R6 de
L' AMENDEMENT No.180**

au PLAN OFFICIEL
de la VILLE D'OTTAWA
Modifiant l'Annexe A
Plan des politiques en milieu rural

-  LANDS REDESIGNATED FROM "GENERAL RURAL AREA" TO "AGRICULTURAL RESOURCE AREA"
TERRES DONT LA DÉSIGNATION EST PASSÉE DE « ZONE RURALE GÉNÉRALE » À « ZONE DE RESSOURCES AGRICOLES »
-  LANDS REDESIGNATED FROM "RURAL NATURAL FEATURES AREA" TO "AGRICULTURAL RESOURCE AREA"
TERRES DONT LA DÉSIGNATION EST PASSÉE DE « ZONE RURALE À CARACTÉRISTIQUES NATURELLES » À « ZONE DE RESSOURCES AGRICOLES »

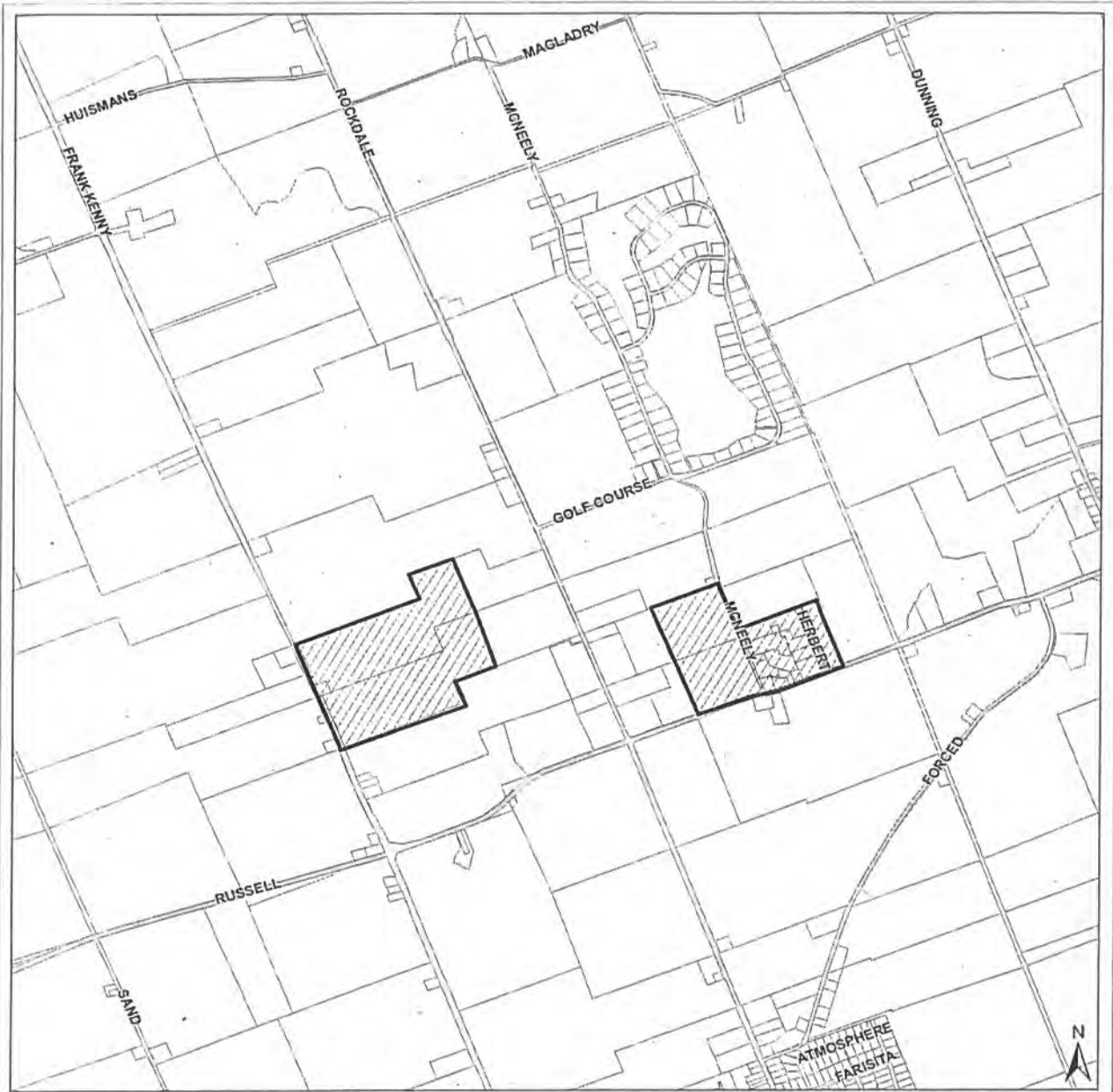

Prepared by:
 Planning, Infrastructure and Economic Development Department,
 Communications, Mapping and Graphics Unit

Ottawa

Préparé par: Services de la planification,
 de l'infrastructure et du développement économique,
 Unité des Communications, cartographie et graphiques

DOI-01-16-0014 16-1261-A

\\s\apps\services\OPAs\2016\OPA 180 Map R12.mxd

Revision: 06/2017 Rev #: 1

(C) This document is owned by Revenue Enterprises Inc. and its suppliers. All rights are reserved. This may not be reproduced without permission. Tous droits réservés. Tous droits réservés. Non peut être reproduit sans autorisation.

Scale - N.T.S. / Echelle N.A.E.

**SCHEDULE R12 to
 AMENDMENT NO.180**
 to the OFFICIAL PLAN
 for the CITY OF OTTAWA
**Amending Schedule A
 Rural Policy Plan**

**ANNEXE R12 de
 L' AMENDEMENT No.180**
 au PLAN OFFICIEL
 de la VILLE D'OTTAWA
**Modifiant l'Annexe A
 Plan des politiques en milieu rural**

 LANDS REDESIGNATED FROM "AGRICULTURAL RESOURCE AREA" TO "GENERAL RURAL AREA"
 TERRES DONT LA DÉSIGNATION EST PASSÉE DE « ZONE DE RESSOURCES AGRICOLES » À « ZONE RURALE GÉNÉRALE »

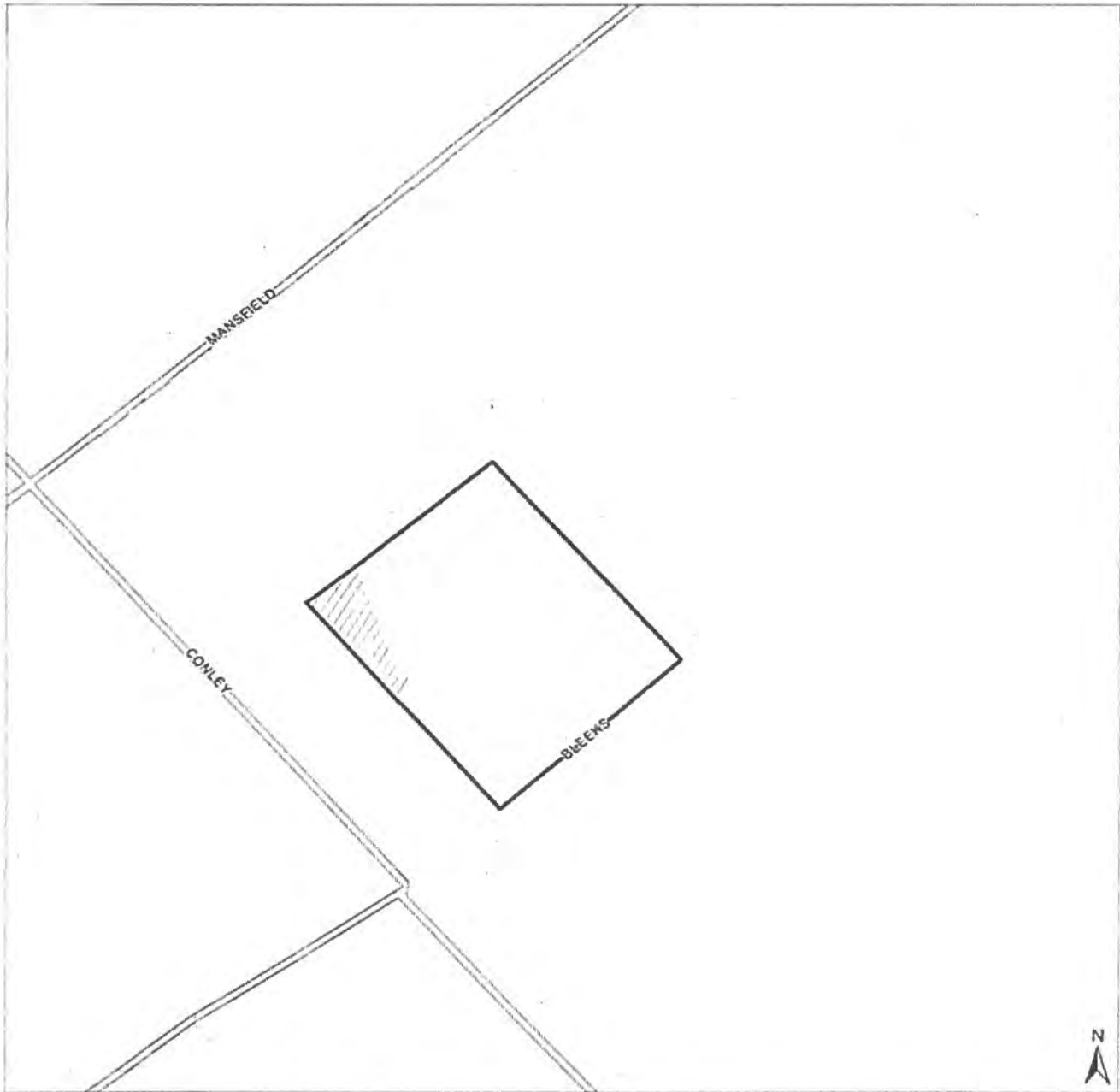

Planning Information and E-mail: planning@ottawa.ca
 Community Mapping Unit



1-800-361-0114 16-1261-V

Revised: Oct 2017 Rev #: 1

Scale: 1:10,000

**SCHEDULE R21 to
 AMENDMENT NO.180**

to the OFFICIAL PLAN
 for the CITY OF OTTAWA

**Amending Schedule A
 Rural Policy Plan**



LANDS REDESIGNED FROM 'GENERAL RURAL RESERVE AREA' TO 'GENERAL RURAL AREA'
 TERRIS DONT LA DESTINATION EST PASSÉE DE 'ZONE DE RESERVE RURALES GÉNÉRALES' À 'ZONE RURALE GÉNÉRALE'

**ANNEXE R21 de
 L' AMENDEMENT No.180**

au PLAN OFFICIEL
 de la VILLE D'OTTAWA

**Modifiant l'Annexe A
 Plan des politiques en milieu rural**